

Marco ventana 40 cam.16
Ref: 4001

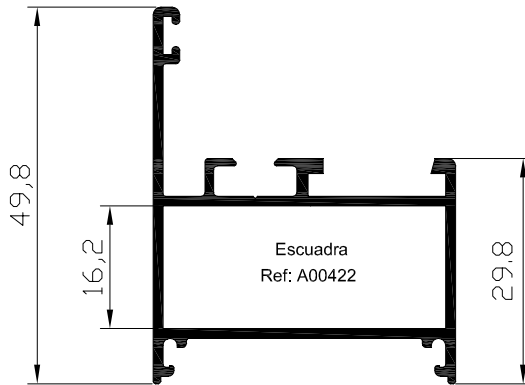

Marco ventana 40 cam.14
Ref: 4011

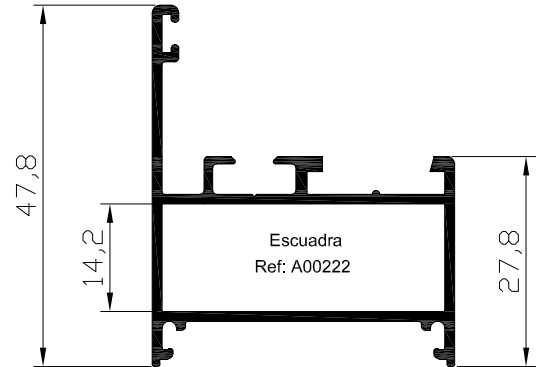

Marco puerta 40
Ref: 4002

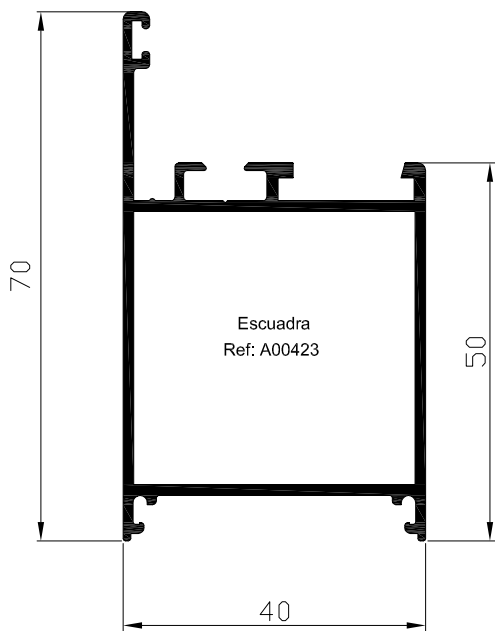

Marco c.solape 40
Ref: 4021

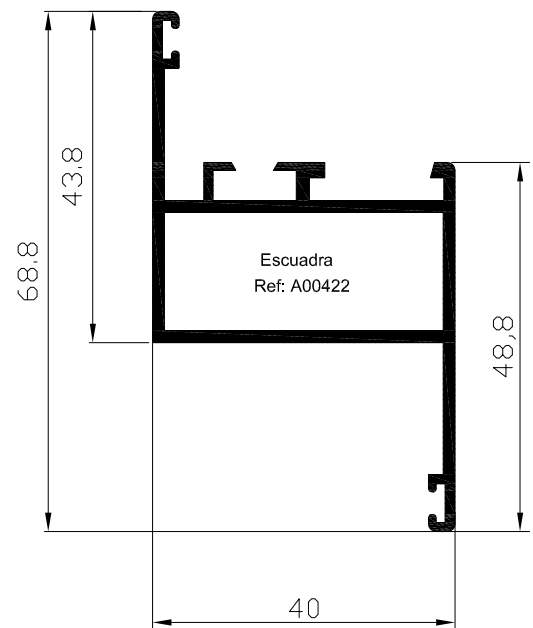

Marco ventana 45
Ref: 4501

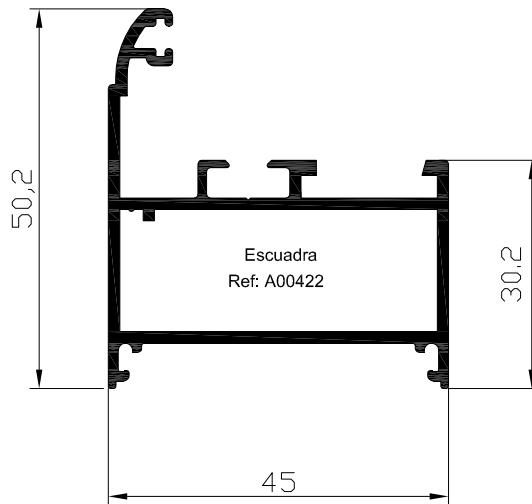

Marco puerta 45
Ref: 4502

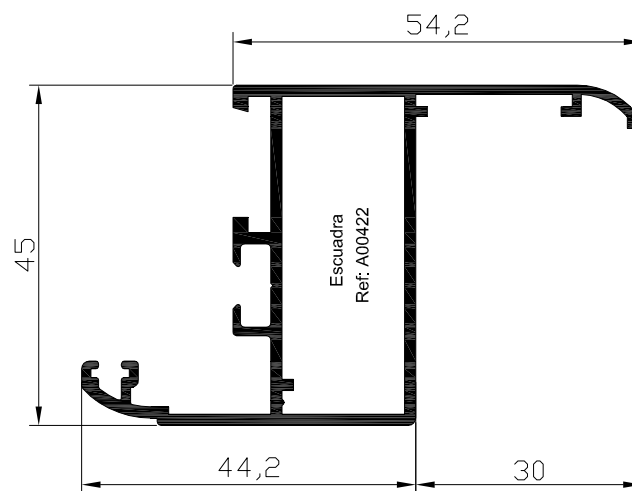
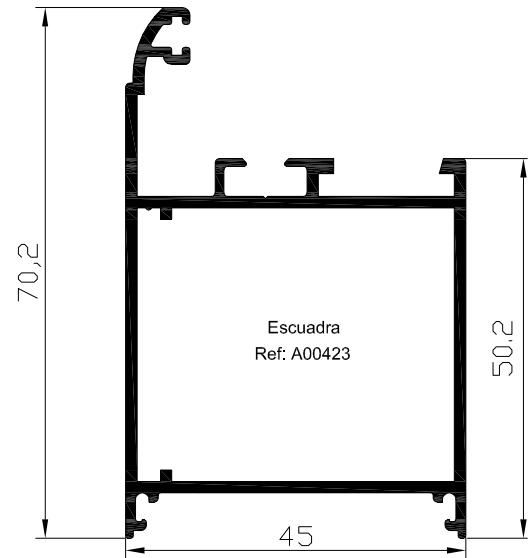

Marco c.solape 45
Ref: 4521

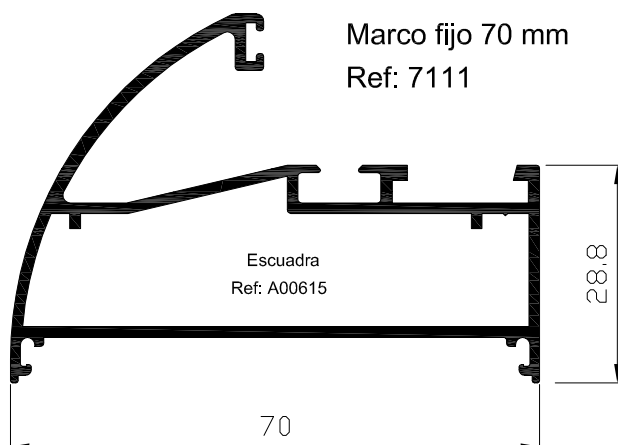

Marco fijo 70 mm
Ref: 7111

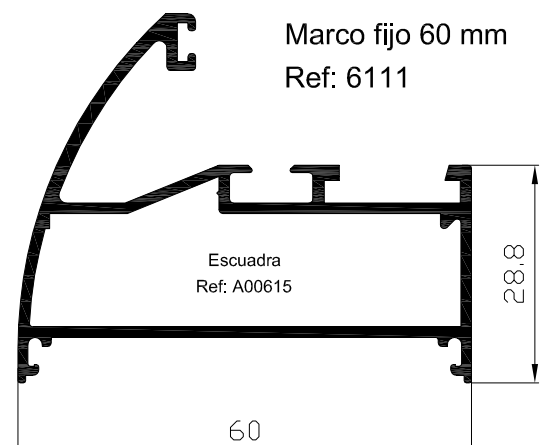

Marco fijo 60 mm
Ref: 6111

Hoja ventana 40
Ref: 4004

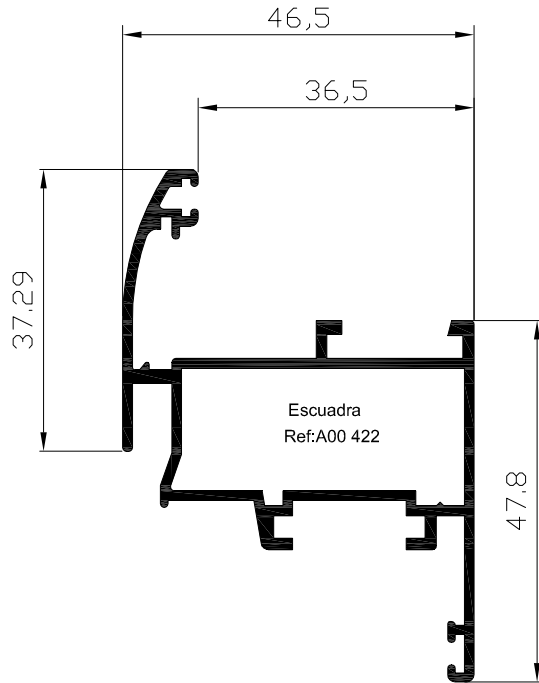

Hoja ventana 45
Ref: 4504

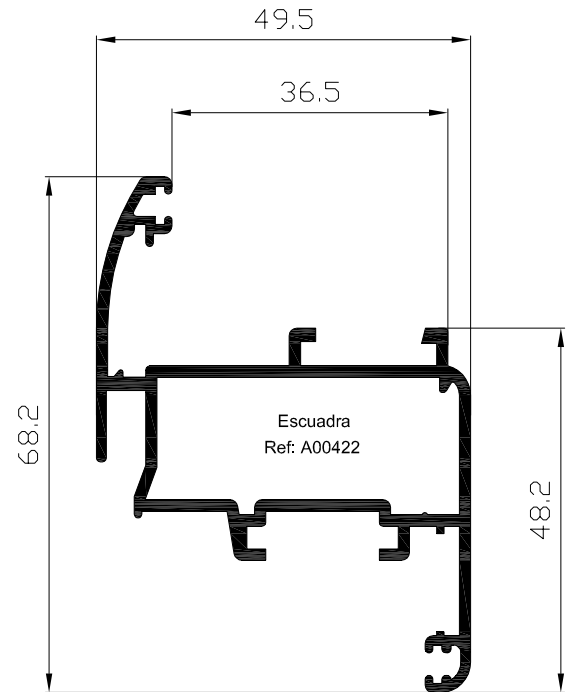

Hoja puerta 40
Ref: 4005

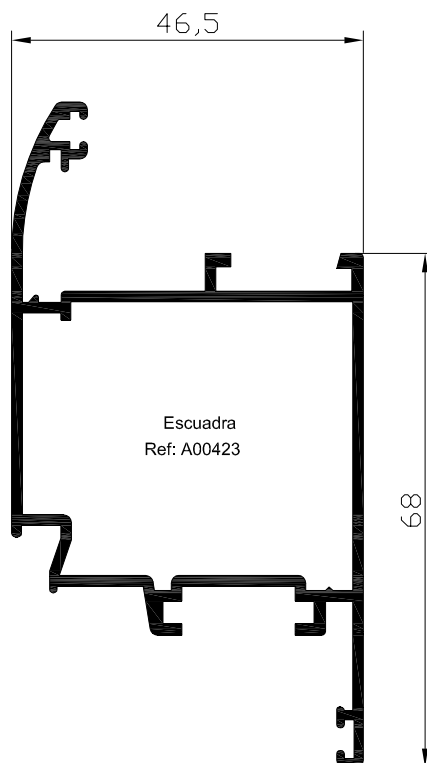

Hoja puerta 45
Ref: 4505

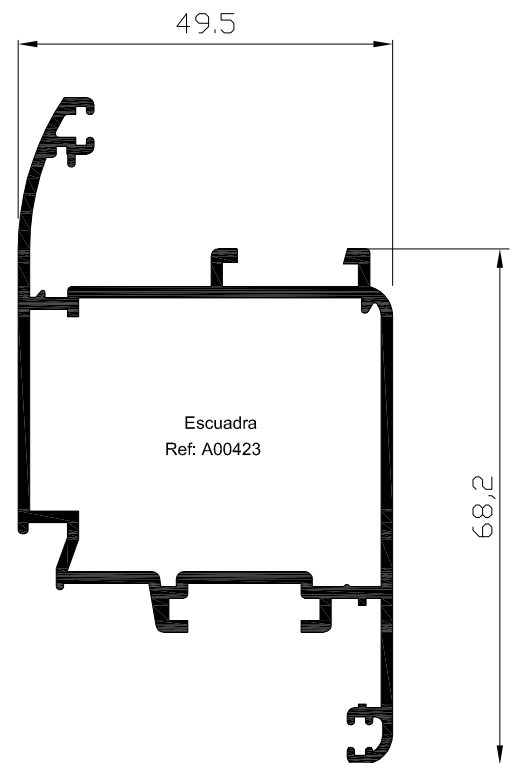

Hoja ventana 40 cam.14
Ref: 4924

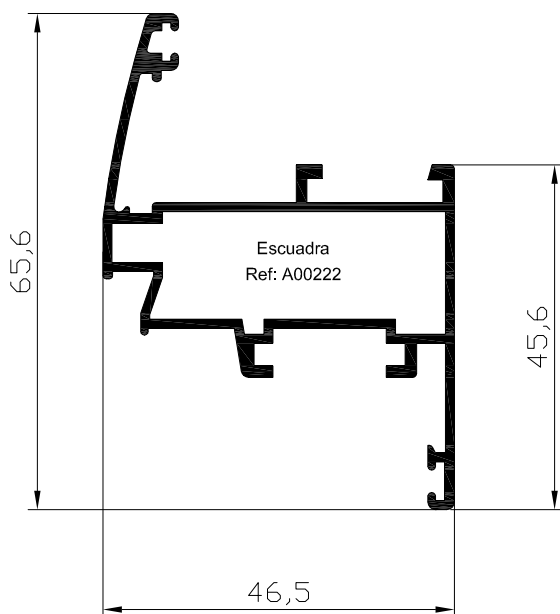

Hoja ventana 40 cam.16
Ref: 4904

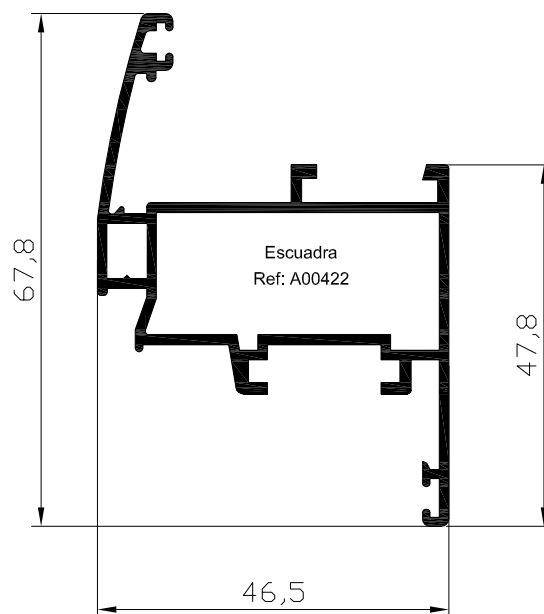

Hoja puerta 40
Ref: 4905

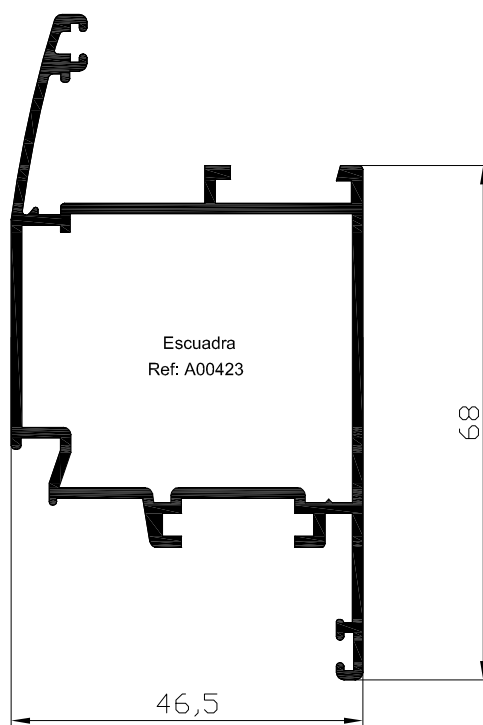

Hoja apert.ext ventana 40
Ref: 4014

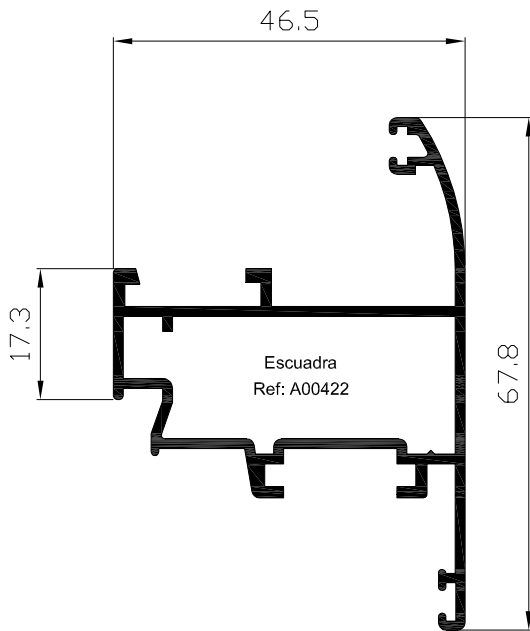

Hoja apert.ext puerta 40
Ref: 4015

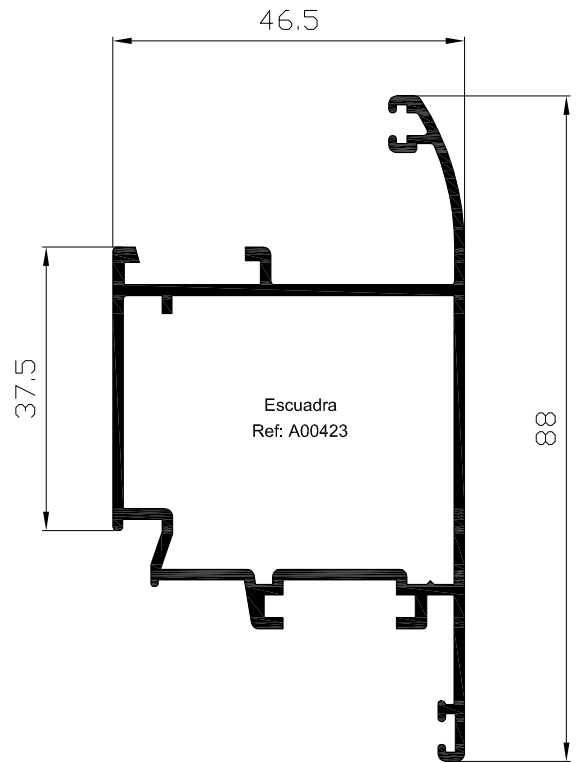

Hoja apert.ext ventana 45
Ref: 4514

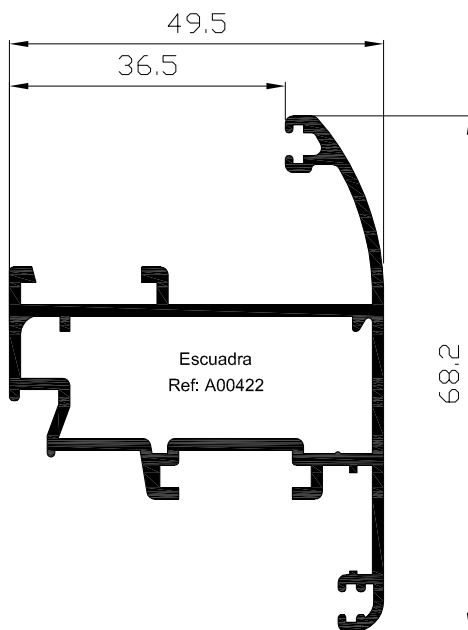

Hoja apert.ext puerta 45
Ref: 4515

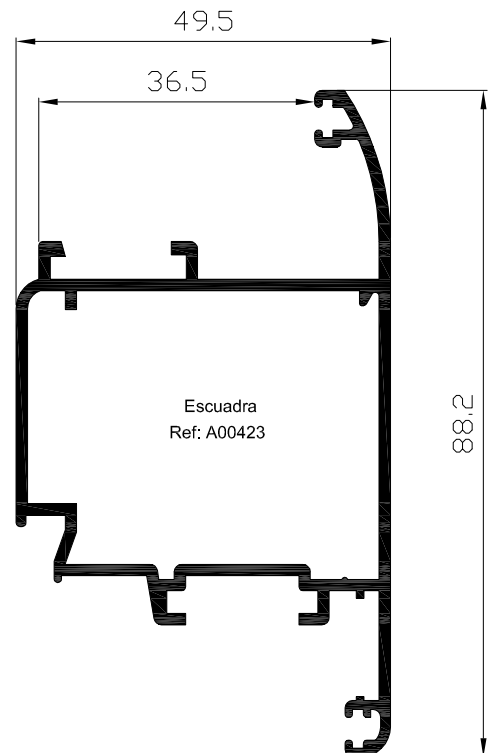

Hoja ventana 45
Ref: 5904

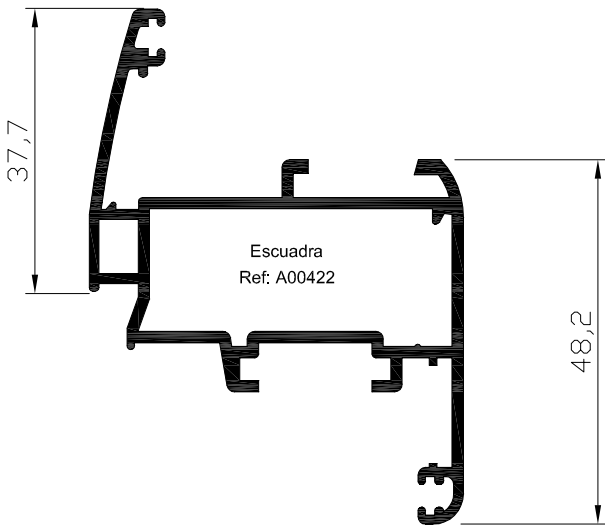

Hoja puerta 45
Ref: 5905

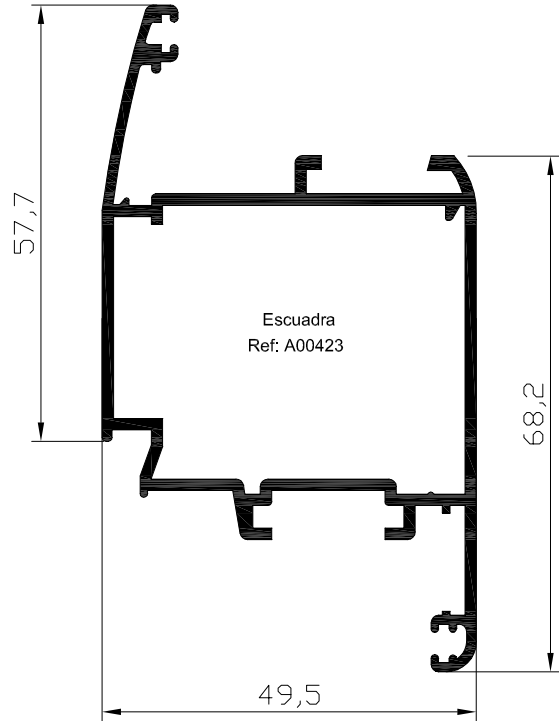

Hoja ajunquillada ventana 40
Ref: 4034

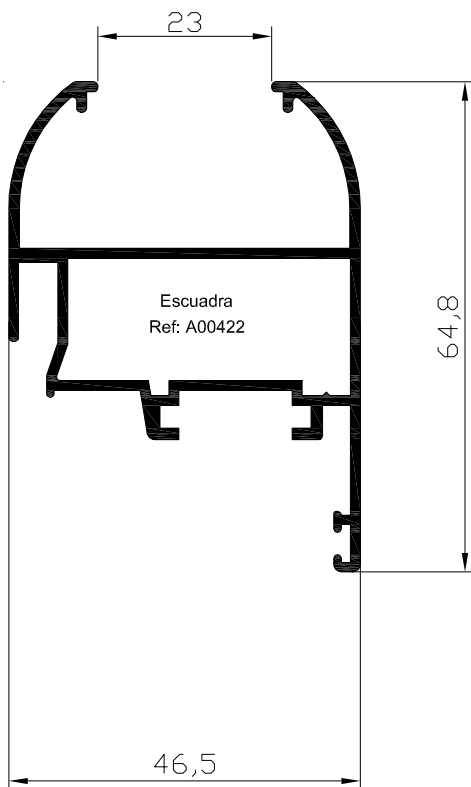

Hoja ajunquillada puerta 40
Ref: 4035

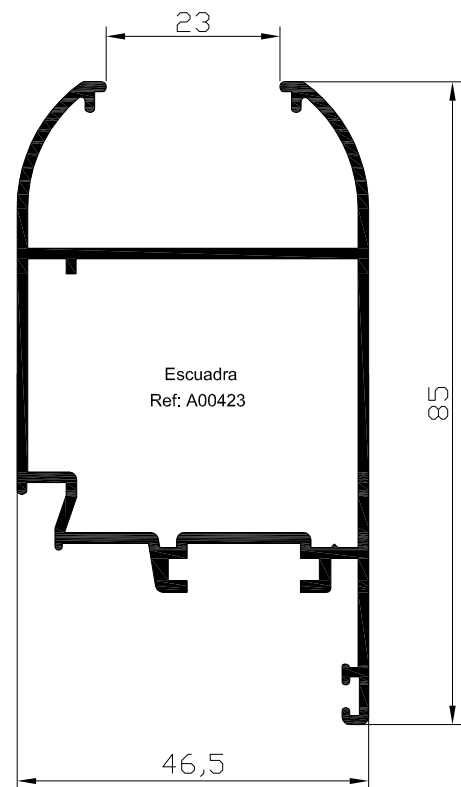

Hoja apert.ext ventana 40
Ref: 4914

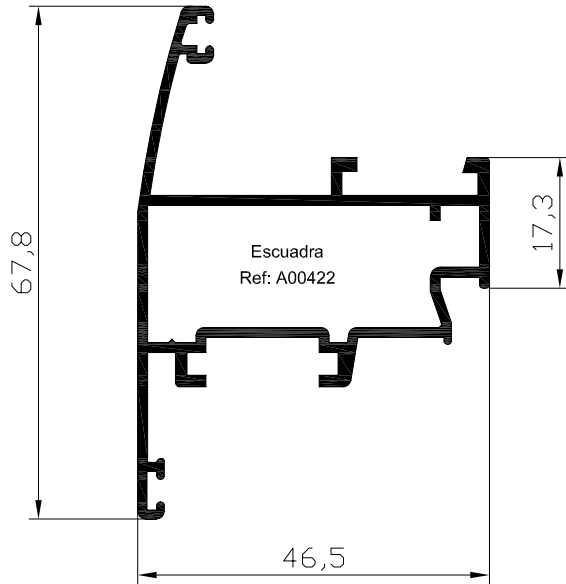

Hoja apert.ext puerta 40
Ref: 4915

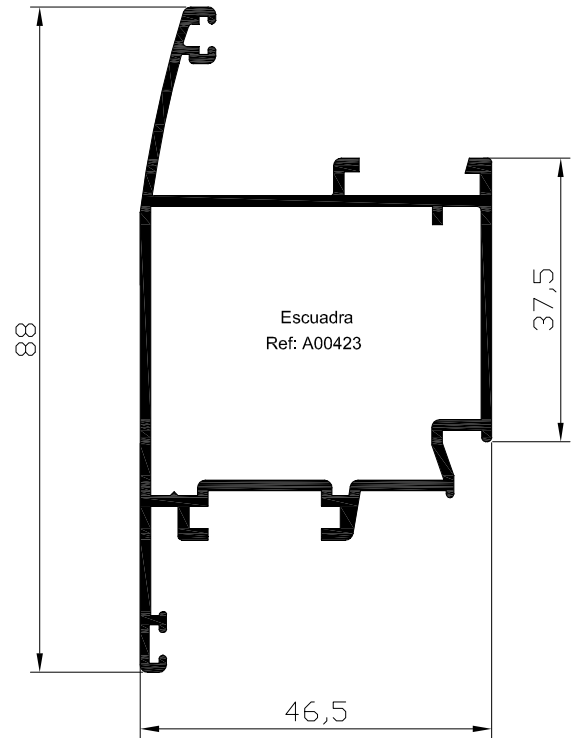

Hoja apert.ext ventana 45
Ref: 5914

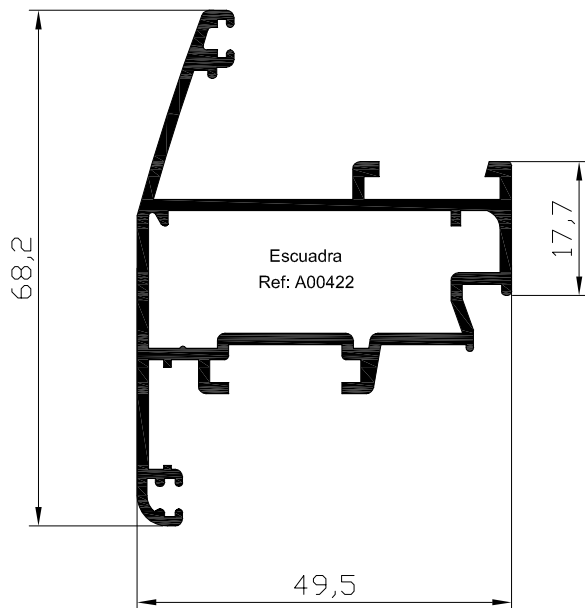

Hoja apert.ext puerta 45
Ref: 5915

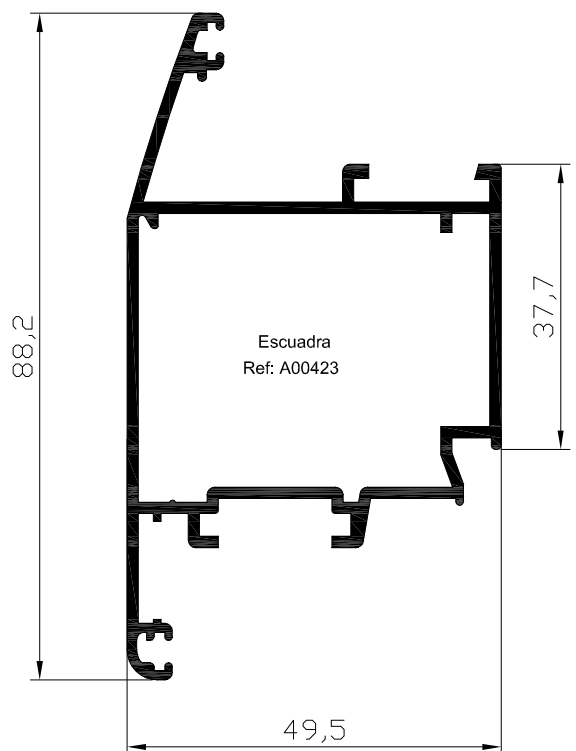

Zócalo parteluces
Ref: 4007

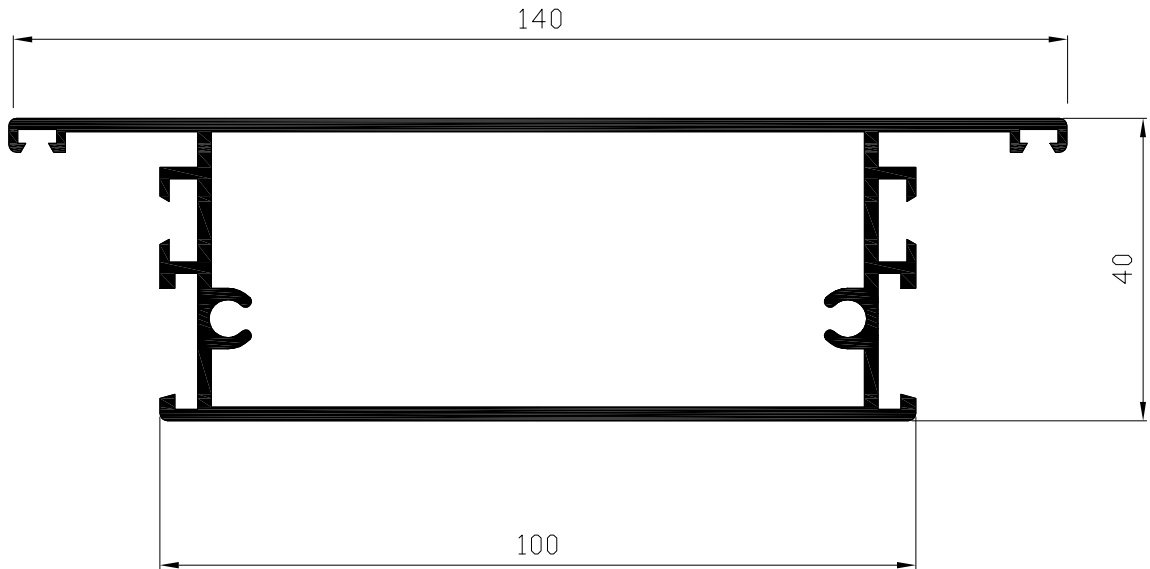

Marco zócalo
Ref: 4017



Travesaño ventana
Ref: 4008

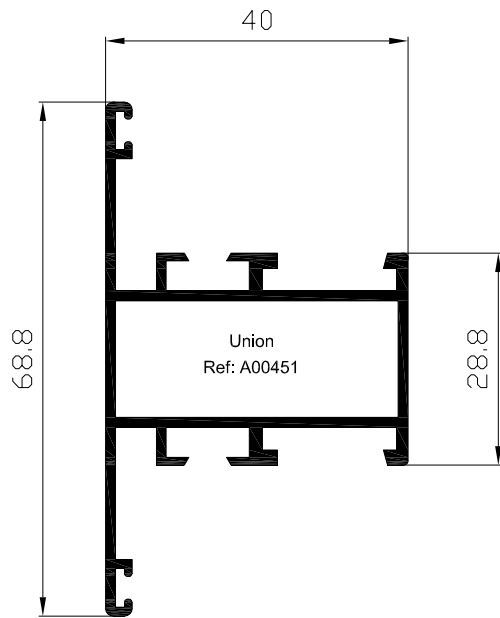

Travesaño puerta
Ref: 4018

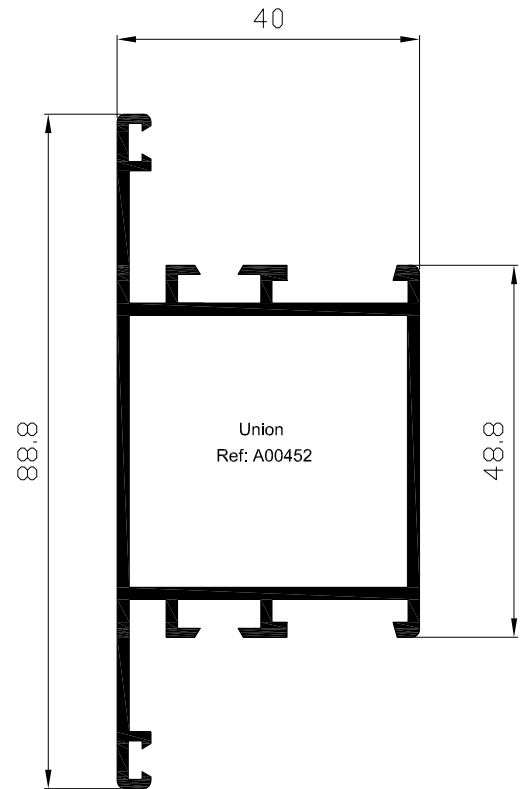

Inversor TOP.40-45
Ref: 4006

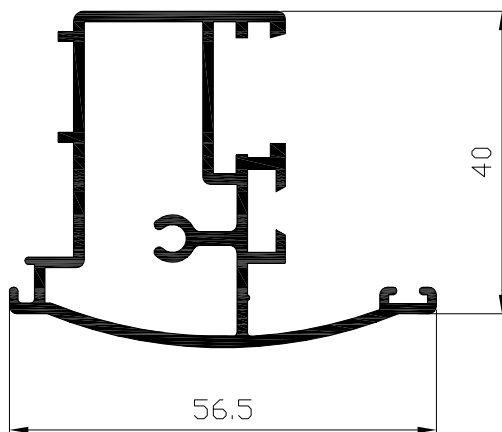

Inversora pivotante TOP.40-45
Ref: 4506

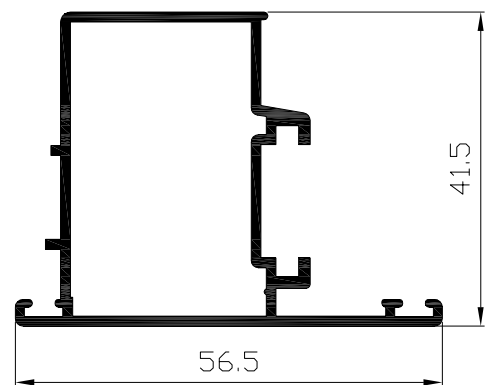

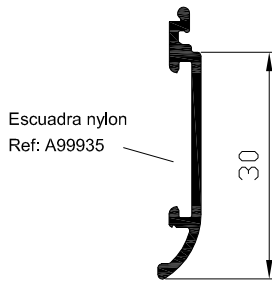

Solape 30 mm
Ref: 4130



Solape 50 mm
Ref: 4150

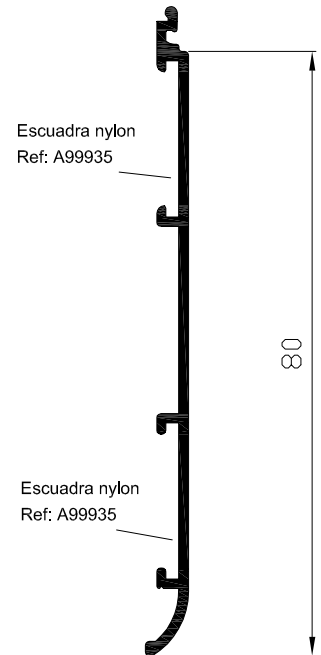

Solape 80 mm
Ref: 4180

Solape resalte
Ref: 4132

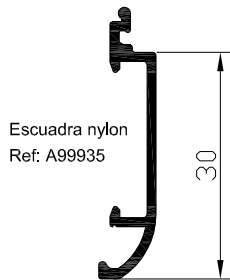

Solape compacto
Ref: 4133

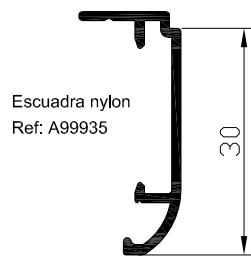

Porticon tapaluz
Ref: 9011

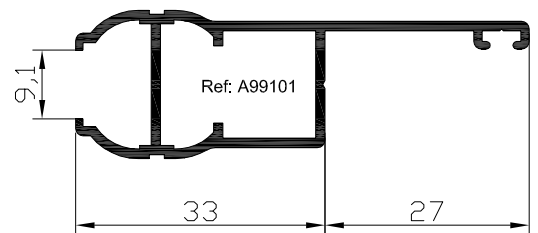

Pletina falleba
Ref: 4110

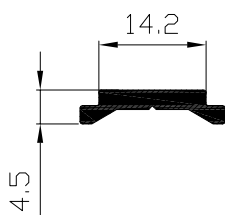

Unión de marcos
Ref: 8111

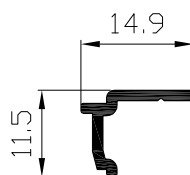

Vierteaguas
Ref: 4350

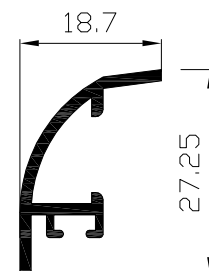

Esquinero 90°
Ref: 4520

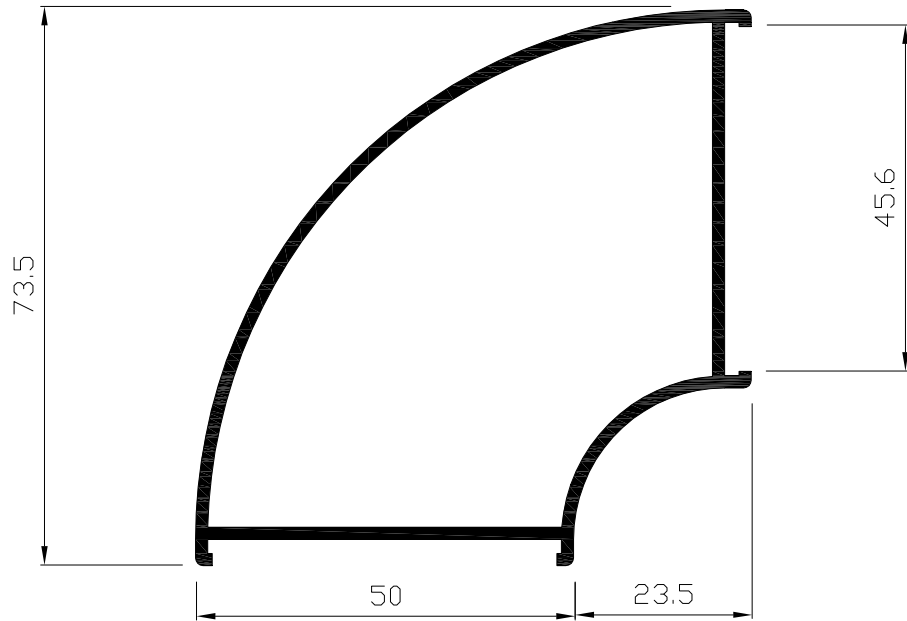

Esquinero 90°
Ref: 4321

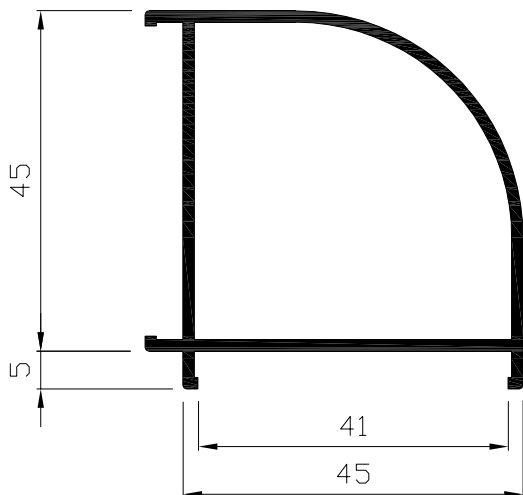

Esquinero graduable TOP.40-45
Ref: 4120

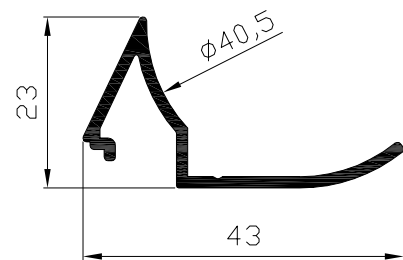

HUECO 9 mm

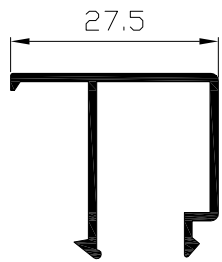

Junquillo recto
Ref: 4101

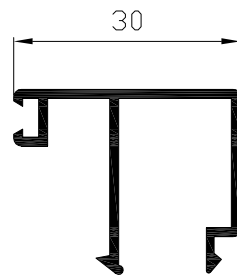

Junquillo recto
Ref: 4108

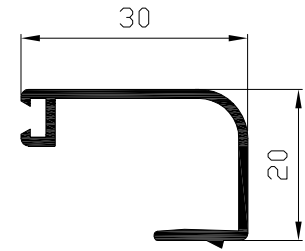

Junquillo curvo c.grapa
Ref: 4118

HUECO 6.5 mm

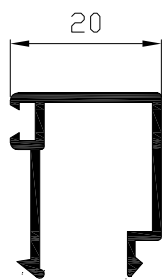

Junquillo recto
Ref: 4103

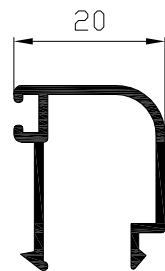

Junquillo curvo
Ref: 4123

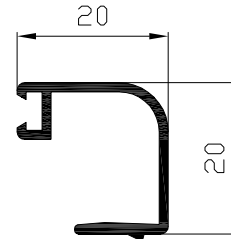

Junquillo curvo c.grapa
Ref: 4113

HUECO 16.5 mm

HUECO 20.5 mm

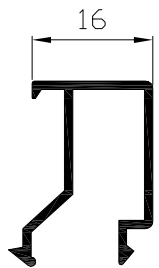

Junquillo recto
Ref: 4104

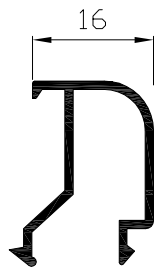

Junquillo curvo
Ref: 4124

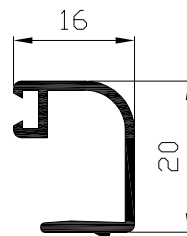

Junquillo curvo c.grapa
Ref: 4114

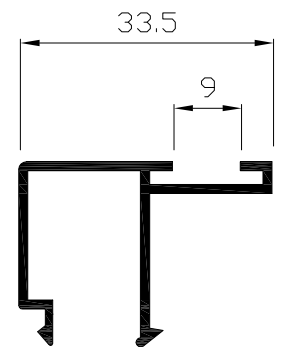

Junquillo zócalo
Ref: 4107

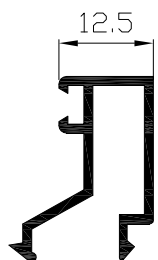

Junquillo recto
Ref: 4105

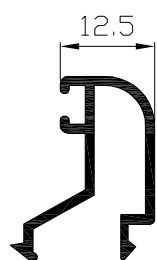

Junquillo curvo
Ref: 4125

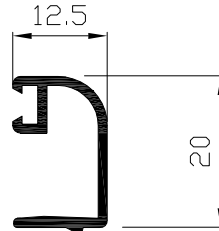

Junquillo curvo c.grapa
Ref: 4115

HUECO 24 mm

HUECO 29 mm

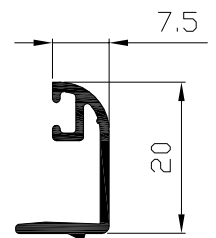

Junquillo curvo c.grapa
Ref: 4116

SECCION HORIZONTAL VENTANA UNA HOJA ABATIBLE

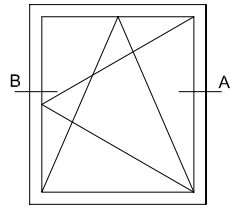

SECCION A

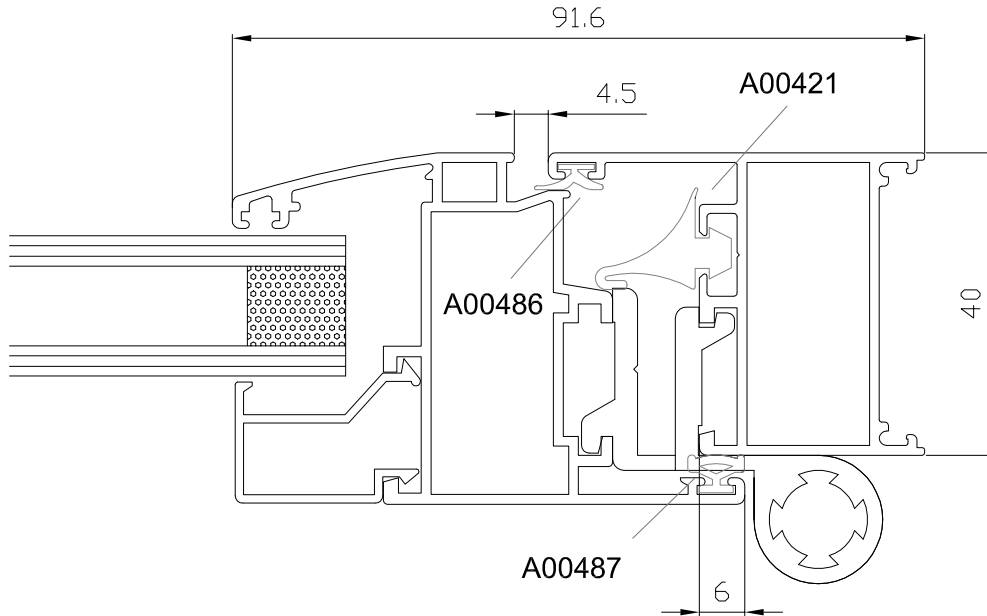

SECCION B

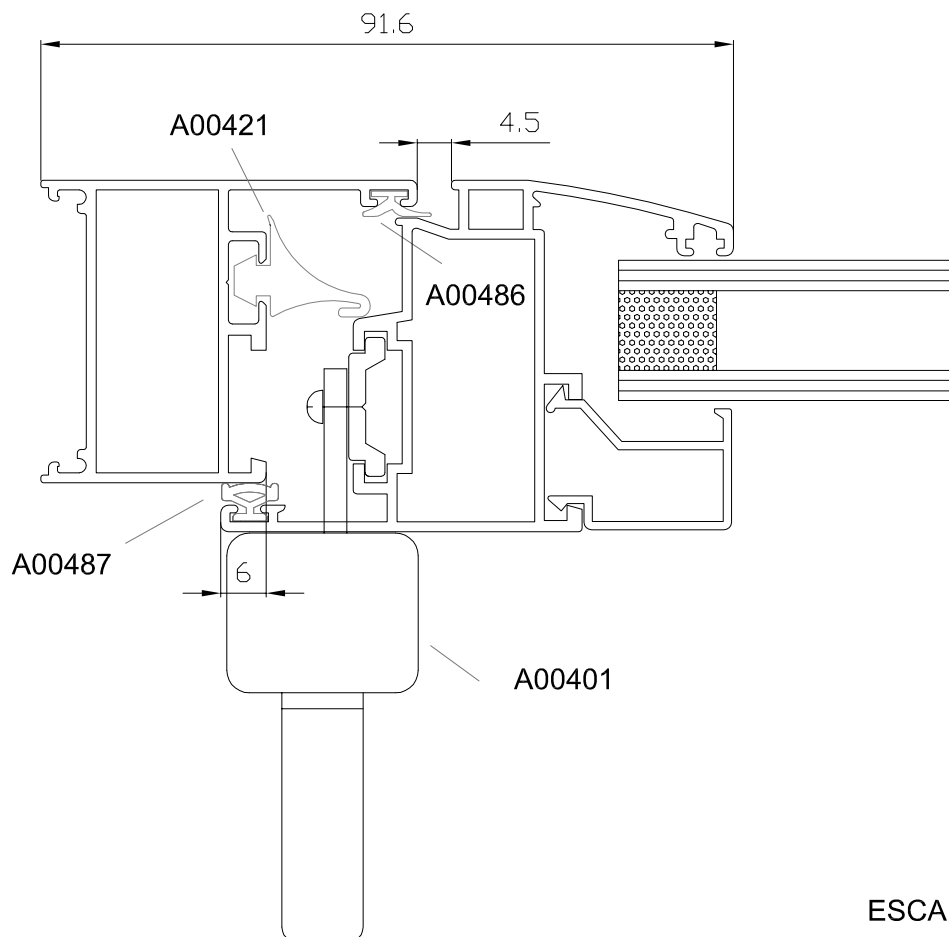

ESCALA 1:1

SECCION HORIZONTAL VENTANA DOS HOJAS ABATIBLES

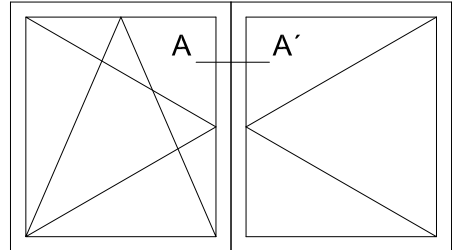

SECCION A-A'

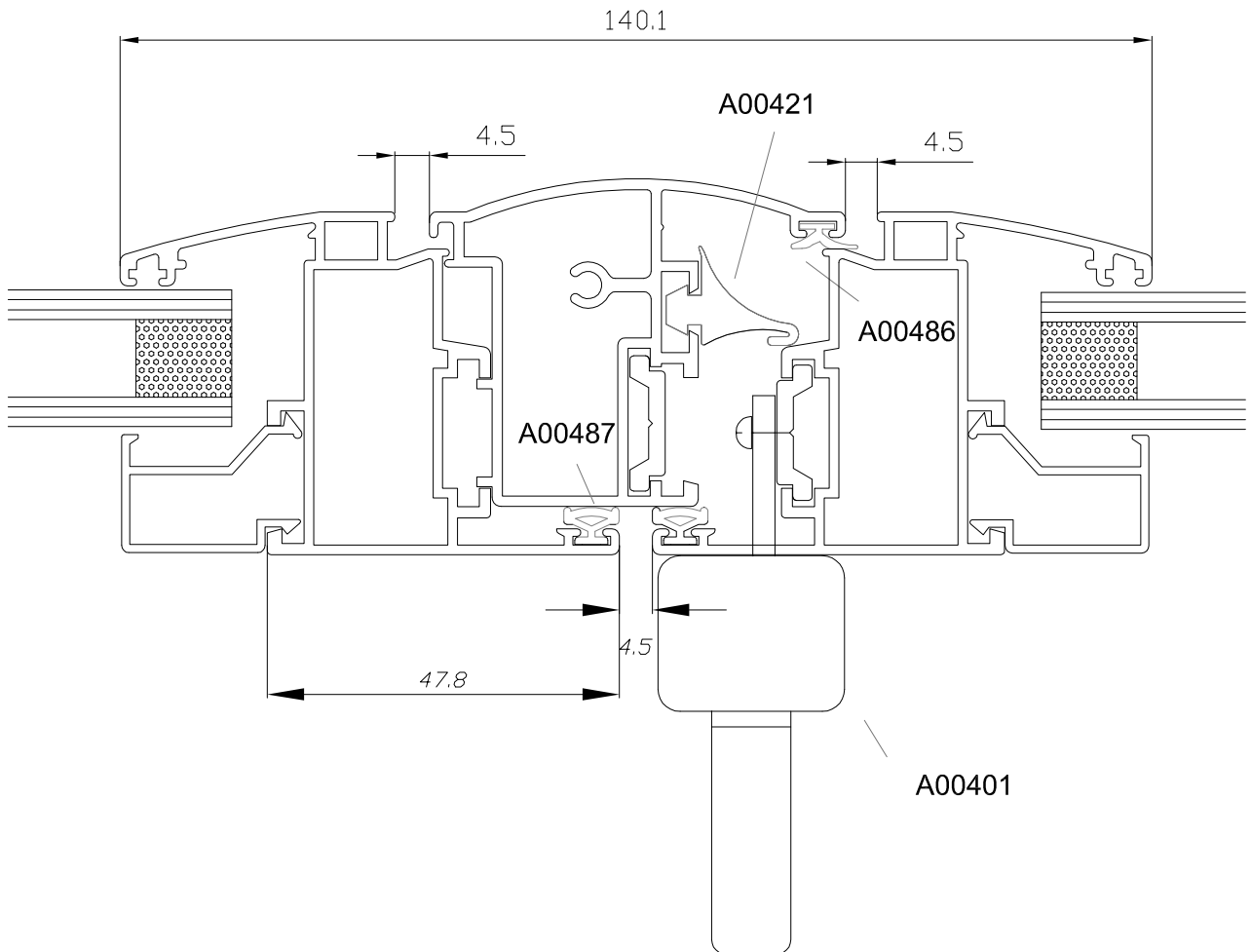

ESCALA 1:1

DETALLE COLOCACION SOLAPE MULTIPLE

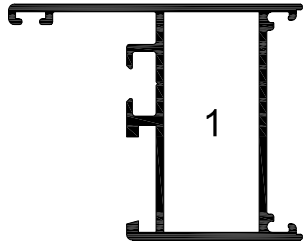

PREPARACION DE SOLAPE
CORTADO A INGLETE

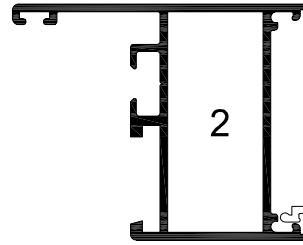

LLEVAR A TOPE

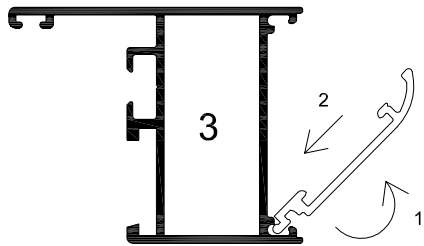

1º GIRAR
2º DESPLAZAR

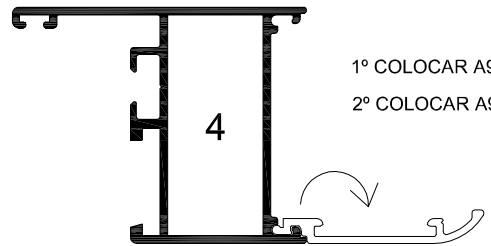

1º COLOCAR A99935
2º COLOCAR A99035

A99935

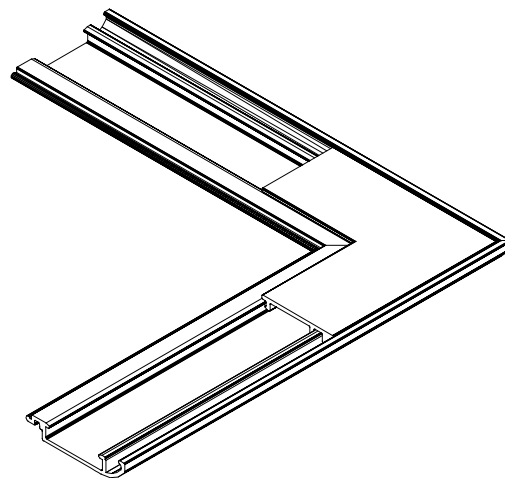
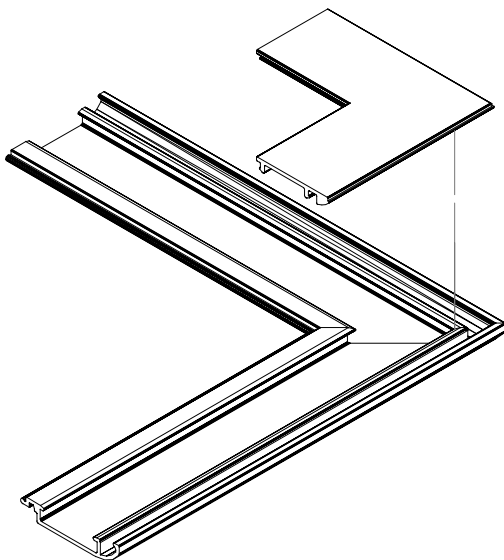

DETALLE COLOCACION SOLAPE MULTIPLE

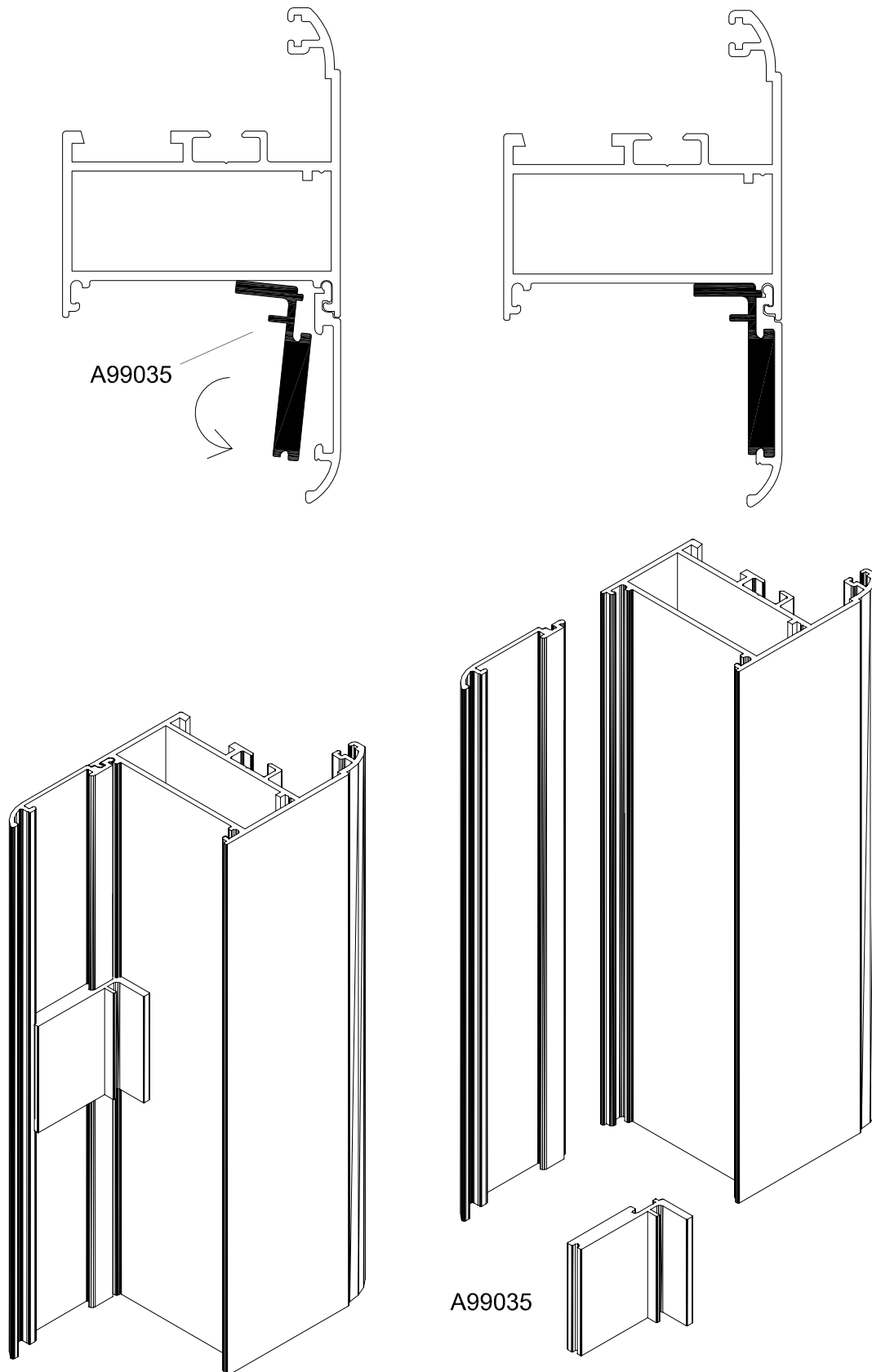

SECCION VERTICAL PUERTA DE CALLE

SECCION A

La ref: 4007 puede ser sustituida
por la ref: 4017, en cuyo caso no haria
falta el junquillo zocalo

4007

4107

A00388

VIERTEAGUAS

4350

TACO VIERTEAGUAS

A00319

A00318

0.0

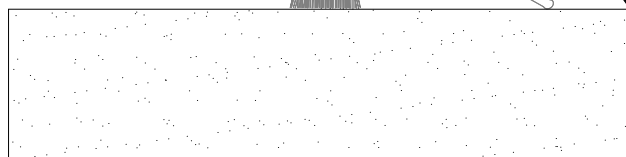
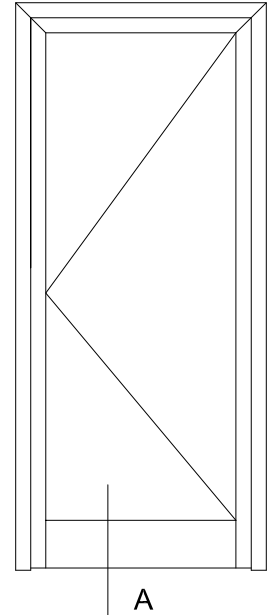

ESCALA 1:1

RELACION DE ESCUADRAS DE ALINEACION

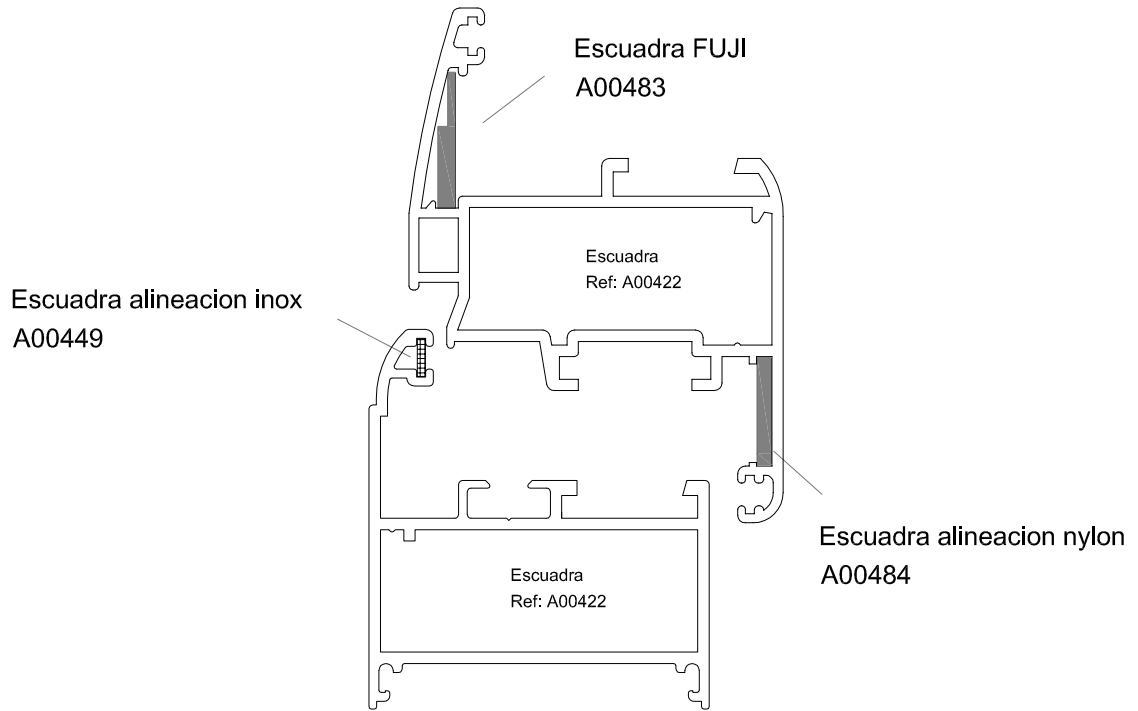

ESCALA 1:1

DETALLE MONTAJE PORTICON TAPALUZ

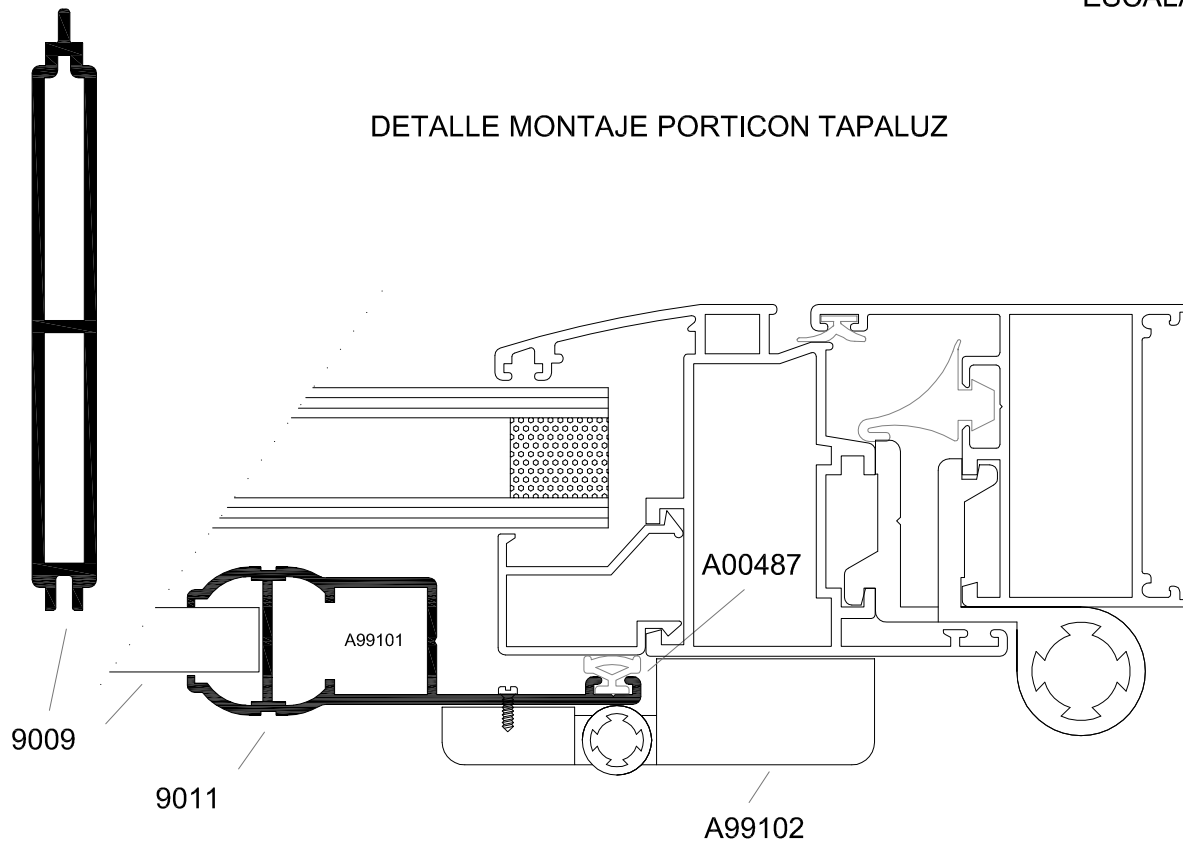

DETALLE UNION DE MARCOS

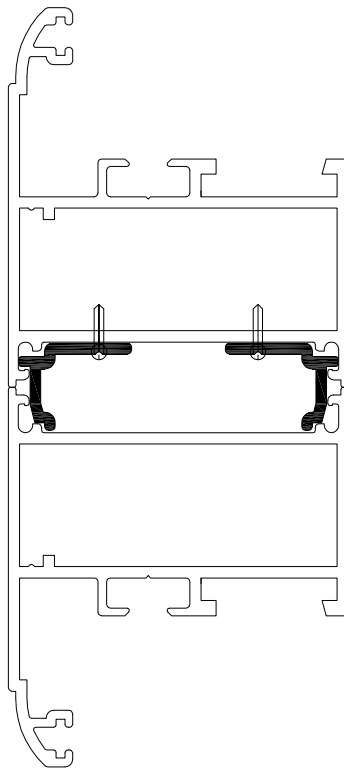

DETALLE ESQUINERO GRADUABLE

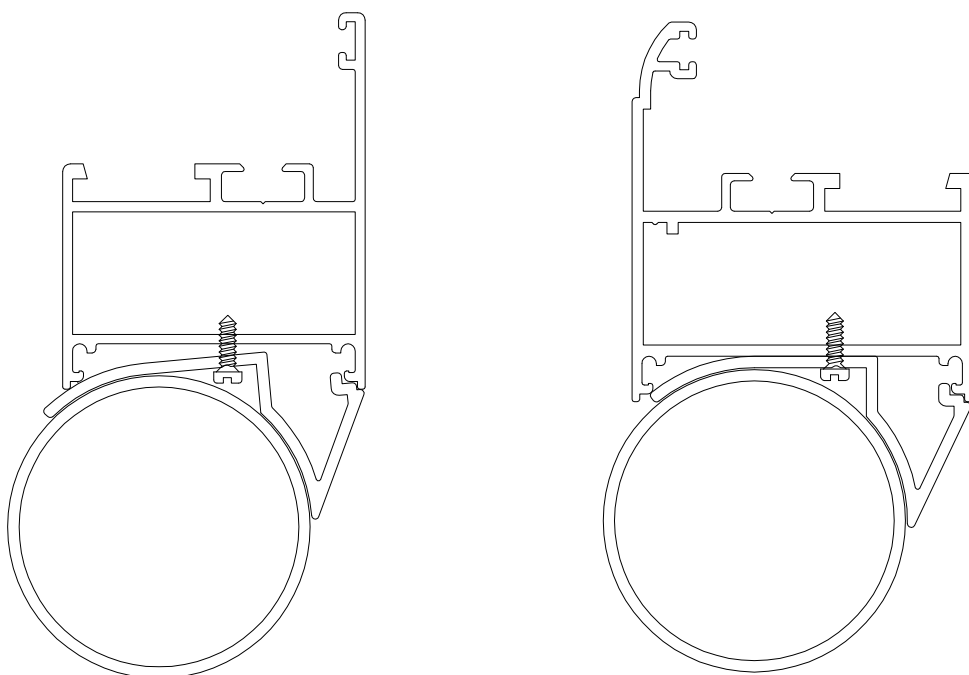

MONTAJE SOLAPE COMPACTO

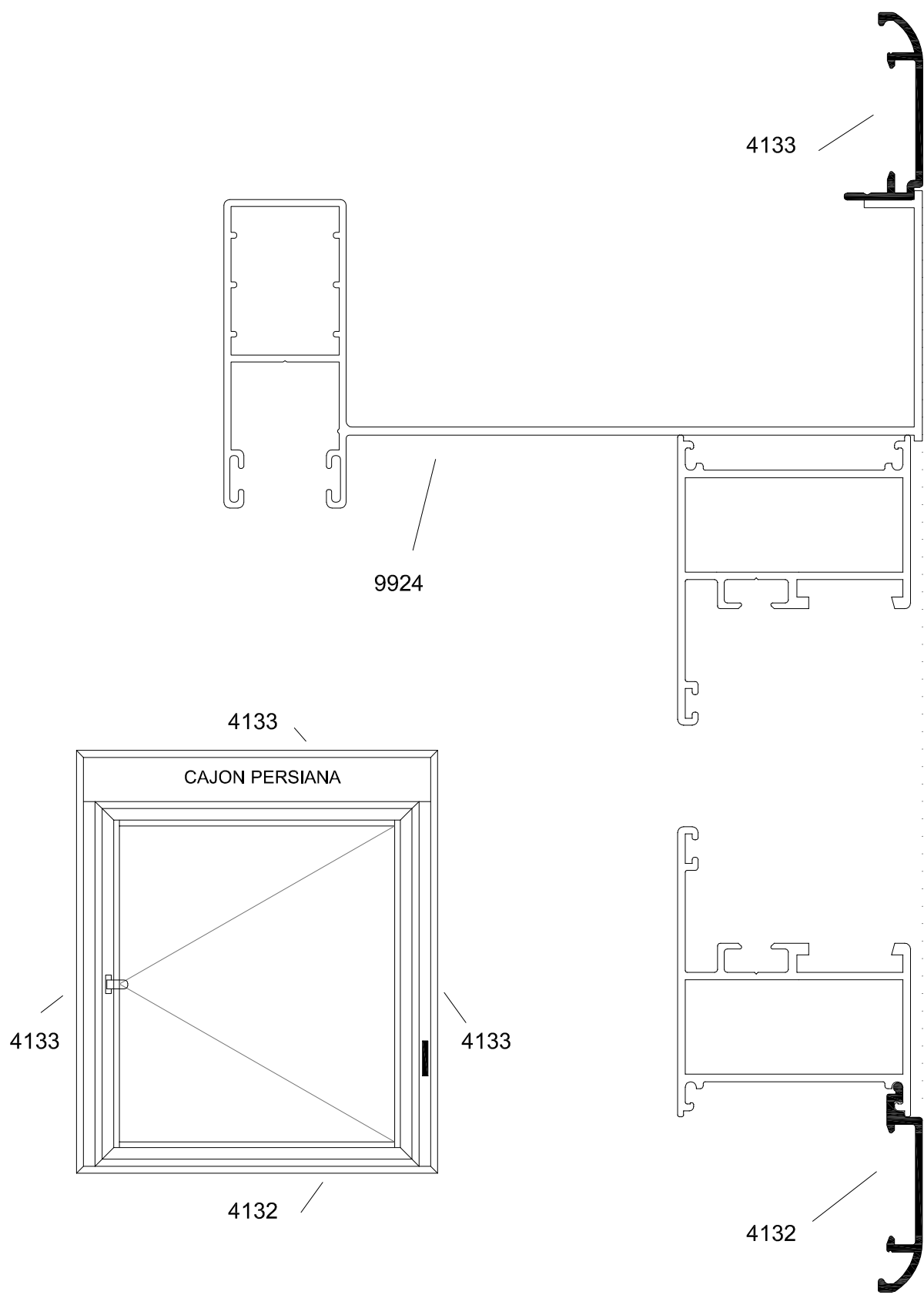

* Montaje válido para cualquier serie con el mismo canal de solape.

ESCALA 1:1